

# *BaByliss*<sup>®</sup>MEN

THE CREWCUT  
7758U

## **SAFETY CAUTIONS**

- Original instructions. Read these safety precautions carefully before using the unit! This appliance should only be used as described within this instruction booklet. Please retain for future reference.

## **IMPORTANT CHILD SAFETY**

- **ALWAYS** keep out of the reach of very young children (during and after use).
- This appliance should not be used, cleaned or maintained by children.
- Always take extra care if used on children or near children.
- Do not use on very young children.

## **IMPORTANT SAFETY**

- **WARNING!** Do not use this appliance near bathtubs, showers, basins or other vessels containing water. 
- Do not immerse the appliance in water or other liquids. Keep the appliance dry.
- **UK Only:** Do not use this appliance in the bathroom.

- **Outside the UK:** If using the appliance in a bathroom, unplug after use as the proximity of water can be dangerous even if the appliance is switched off. For additional protection the installation of a residual current device (RCD) with a rated residual operating current not exceeding 30mA is advisable in the electrical circuit supplying the bathroom. Ask your installer for advice.
- The appliance's charging stand and/or adaptor must be kept away from sources of water so that they do not fall into the water.
- **CAUTION!** Keep the power cord and the appliance dry. For appliances with a removable power supply unit, remove the power cord before cleaning or using the appliance under running water.
- Always inspect the appliance before use for noticeable signs of damage. Do not use if damaged or if the appliance has been dropped. In the event of damage contact the Conair Customer Care Line (refer to 'UK After Sales Service' section for further information).
- Do not use the appliance if the charging adaptor or lead is damaged. In the event of damage, discontinue use immediately. If the charging adaptor or lead is damaged, it must be replaced by the manufacturer. Return the appliance to the Customer Care Centre (refer to 'UK After Sales Service' section for further information). No repair must be attempted by the consumer.
- Only use the attachments supplied with this appliance.
- **WARNING!** For the purposes of recharging the battery, only use the detachable charging supply unit provided

with this appliance (CA78). This  symbol indicates there is a detachable power supply for means of charging.

- Do not leave the appliance unattended when switched on.
- Do not leave the appliance plugged in for more than 24 hours.
- Unplug immediately if any problems occur during use.
- Do not place the appliance on any surface whilst in operation.
- Special care is required when using the appliance close to the ears, eyes and face.
- This appliance may be used by children aged from 8 and older and people with reduced physical, sensory or mental capabilities or lack of experience and knowledge if they have been given supervision or instruction on the safe use of the appliance and understand the hazards involved. Children must not play with the appliance.
- This product contains a Lithium Ion rechargeable battery that is not to be removed from the appliance for charging. The batteries in this appliance are non-replaceable. Batteries must be disposed of safely at the end of life. Please take to a recycling centre for safe disposal. If the battery leaks, avoid touching it and dispose of it at a recycling centre.
- The supply terminals are not to be short circuited.
- For domestic use only.
- This product complies fully with all appropriate EU and UK Legislation and the standards relevant to this type and class of appliance. We are an ISO9001:2015 certified company that continually evaluates our Quality

Management System performance. If you have any queries regarding product safety and compliance, please contact the Conair Customer Care Line (refer to 'UK After Sales Service' section).

## **INSTRUCTIONS FOR USE**

**IMPORTANT!** Only use the adaptor and attachments supplied with this appliance.

### **General**

- Always inspect the appliance for noticeable signs of damage. Do not use if damaged.
- Always inspect the appliance before use to ensure the clipper blades are free from hair, debris etc.

### **Oiling Instructions**

- For optimum cutting performance, it is highly recommended to oil the blades after every use.
- When using the oil for the first time, unscrew the cap and cut off the very end of the plastic tube with a pair of scissors.
- Switch the appliance on.
- Holding the clipper gently squeeze the oil tube and apply 2 drops directly onto the blades.
- Leave the unit on for a further few seconds to allow the oil to thoroughly spread along the blades.
- Switch off the unit and remove any excess oil by gently dabbing with a cloth before using on hair.

### **Charging the appliance**

- This clipper is equipped with lithium ion batteries.
- Before using for the first time, the appliance should be fully charged continuously for 3 hours. This initial super-charge ensures optimum power performance to ensure smooth fast cutting every time. Maximum battery capacity will only be reached after 3 charging and discharging cycles.

- Plug the charging adapter into a suitable mains power socket and switch on at the wall. A red LED light will continuously flash indicating the clipper is charging. When the battery is fully charged the LED light will remain on.

**Note:** Always charge the clipper with the 'I/O' switch in the OFF position.

- When the clipper is running low on charge, the charging indicator will flash to indicate that there is less than 15% battery capacity remaining. A full charge will provide approximately 75 minutes use. A 30 minute quick charge will provide approximately 15 minutes use.
- If the charging light suddenly starts to flash rapidly, (more than 4 flashes per second) then the appliance is faulty. If this happens then please stop charging and remove the adapter from the mains and contact the Conair Customer Care Line. (See 'UK After Sales Service' section for further information).

### Preserving the Batteries

- In order to maintain the optimum capacity of the rechargeable batteries, the appliance should be fully discharged and then recharged for 3 hours every 6 months approximately.

### Comb Guides

This appliance is supplied with 5 comb guides.

**Note:** The trimmer can be used without any comb guides and will cut to a length of 0.5mm.

Cutting Length	Grade
3mm	#1
6mm	#2
9.5mm	#3
13mm	#4

- The appliance is also supplied with an ear taper guide. This can be used above the ear to get a clean line.

- To attach a comb guide, ensure the appliance is switched off. Position the comb guide over the blades and slide the sides into the slots either side of the blades until it clicks (Fig. 1).

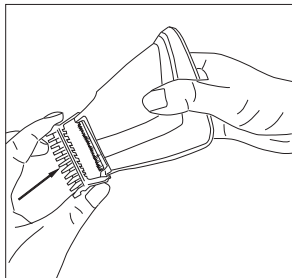

Fig. 1

- To remove the comb guide, place your fingers each side of the comb guide and gently pull down and away from the unit (Fig. 2).

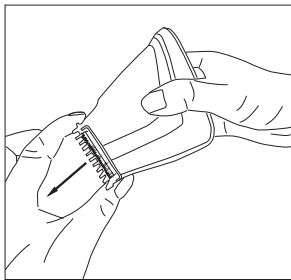

Fig. 2

### Preparation for Use

- For best performance, use on clean, dry hair that has been combed until tangle-free.
  - Prior to use always inspect the head for warts, moles, spots and broken skin. Special care should be taken to avoid injury and cuts.
  - Remove any head jewellery such as earrings and necklaces before use.
- Note:** The appliance should not be used for longer than 20 minutes when operated from the mains.

**WARNING!** The clipper is for use only on the head. Never use the clipper on the face or any other area of the body.

## **Clipping**

- Attach the comb guide length of your choice. Grade 1 = 3mm, Grade 2 = 6mm, Grade 3 = 9.5mm, Grade 4 = 13 mm.
- Switch on the clipper using the on/off sliding switch located on top of the clipper. The blades will start to move and the green LED will illuminate.
- Starting at the nape of the neck, hold the clipper with the teeth of the clipper pointing upwards and the comb guide flat on the head. Slowly move the clipper upwards, through the hair, and towards the front of the head in a forward sweeping motion. Once at the front of the head, engage the opposite blade in a backward sweeping motion to move from the front of the head, back to the nape of the neck.
- Continue with this sweeping motion, running from the nape of the neck to the front of the head until you reach an even length all over.
- To tidy longer hairs around the ears and neckline, simply remove the comb guide and use the blade for neatening edges and shaping sideburns.
- Only apply gentle pressure. Never force the clipper, if resistance is experienced lift clipper away from the head, empty hair from the clipper and resume clipping.
- If using on areas where there are folds of skin, ensure the skin is stretched taught prior to cutting hair in this area.
- If you experience any discomfort stop using immediately.
- If you require a grade 0 (0.5mm) cut, the clipper can be used without a comb guide attached.

**Please Note:** When you first begin cutting your hair, you may notice that some hair is being cut, while others are left long. This is perfectly normal, especially if cutting slightly longer hair because hair grows in many different directions. Continue cutting in a back and forth sweeping motion until all the hair is cut to an even length.

## Removing the blades

- The blades can be removed to aid cleaning.
- To remove the blades, hold the handle with two hands. Place your two thumbs underneath the blades and push the blades away from the handle (Fig. 3).
- Gently blow away any hair trapped beneath the blades.
- The blades can be rinsed under the tap. After rinsing, the blades may need to be oiled. See 'Oiling Instructions'.
- Be sure the blades are dry before reattaching to the clipper body.
- To reattach the blades, put the position rib of the blades into the slot on the clipper body (Fig. 4). Then hold the handle with two hands and press downward with both thumbs (Fig. 5). There will be a clicking noise when the blades are securely attached when attaching the blades.

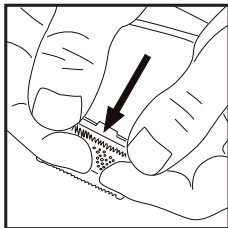

(Fig. 3)

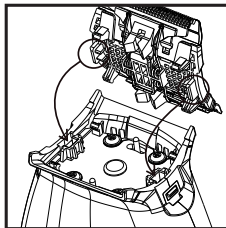

(Fig. 4)

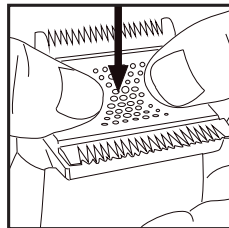

(Fig. 5)

## CLEANING & MAINTENANCE

To maintain optimum performance, the appliance should be cleaned after each use:

- Remove the comb guide after use. Rinse the comb guide under running water and dry thoroughly before storage or use.
- Never place the clipper under running water.
- After each use ensure hair is emptied from the blade area and use the cleaning brush to clean thoroughly.
- It is highly recommended to apply a small amount of oil to the blades before each use.
- Wipe the outside with a damp cloth and dry thoroughly before use or storage.





## **BATTERY DISPOSAL**

This appliance contains Li-ion batteries. To protect the environment this appliance and its batteries must be disposed of safely. At the end of its life, please take this appliance to a recycling centre, where the internal rechargeable battery should be removed by a professional and recycled separately. For more information about the recycling of electrical and battery operated appliances please contact your local council office or your household waste disposal service. For specific enquiries regarding the replacement of batteries in this product please contact our Conair Customer Care Line (See 'UK After Sales Service' section for further information).

## **UK GUARANTEE**

This BaBylissMEN appliance is guaranteed for consumer use for 3 years and is only valid within the United Kingdom.

This guarantee covers consumer use only **i.e.** defects occurring under normal use within the home from date of purchase or date of delivery, whichever is later.

If the product develops a fault due to defects in materials or manufacture **within 12 months** from the date of purchase, to avoid delays and unnecessary inconvenience, where possible please return the product to the point of purchase for an exchange.

If the product develops a fault due to defects in materials or manufacture **after 12 months** from the date of purchase, and within the guarantee period, Conair UK After Sales Service will repair or replace the product.

## **Exclusions**

This guarantee will no longer be valid meaning that The Conair Group Ltd will not be liable to repair or replace your product where:

- 1.) The appliance has been used on a voltage supply other than that which is marked on the product, or advised within this instruction booklet
- 2.) The appliance has been purchased from an unauthorised stockist\*

- 3.) The appliance is used for professional / non domestic usage
- 4.) Repairs or alterations have been attempted by unauthorised persons
- 5.) The failure of the appliance is a direct result of misuse
- 6.) The failure is a result of not following the instructions for use

This guarantee does not cover any cosmetic damage due to misuse of the product nor any damage to persons or property that occurs because of product misuse.

*\*unauthorised stockists include, but are not limited to online auction sites, private sellers and those selling second hand goods, refurbished products etc.*

*Please contact the Conair Customer Care Line on 03705 133 191 (09:00 to 17:00 Monday to Friday) or e-mail [ukinfo@conair.com](mailto:ukinfo@conair.com) for further information on authorised stockists.*

**It is important to retain your proof of purchase. We recommend attaching your receipt to this page.**

**Even where a refund may be applicable, no refund will be provided without a valid receipt or proof of purchase, we will only be able to offer a repair or replacement service. Please note this does not apply if the product was purchased directly from The Conair Group Ltd.**

Guarantees on replacement products run from the original purchase date or date of delivery, whichever is later, and **not** from the date of replacement.

**This guarantee is an additional benefit and does not affect your statutory rights as a consumer.**

If you have any queries regarding this guarantee please contact the Conair Customer Care Line on 03705 133 191 (09:00 to 17:00 Monday to Friday) or e-mail [ukinfo@conair.com](mailto:ukinfo@conair.com)

## **UK AFTER SALES SERVICE**

For further advice on using the appliance, contact the Conair Customer Care Line on 03705 133191 (09:00 to 17:00 Monday to Friday) or email your enquiry to [ukinfo@conair.com](mailto:ukinfo@conair.com).

If you should need to return your appliance to us please send it to the following address:

Customer Care Centre  
Conair Logistics  
Unit 4  
Revolution Park  
Buckshaw Avenue  
Buckshaw Village  
Chorley  
PR7 7DW

Please enclose your name and address, together with a copy of proof of purchase and details of the fault.

**Please note this Instruction Booklet is not the guarantee.**

