

***BaByliss*PRO®**



FXONE LO-PRO CLIPPER

FX829U

BaBylissPRO®

FXONE

Model: FX829U

SAFETY CAUTIONS

- Original instructions. Read these safety precautions carefully before using the unit! This appliance should only be used as described within this instruction booklet. Please retain for future reference.

IMPORTANT CHILD SAFETY

- **ALWAYS** keep out of the reach of very young children (during and after use).
- This appliance should not be used, cleaned or maintained by children.
- Always take extra care if used on children or near children.
- Do not use on very young children.

IMPORTANT SAFETY

- **WARNING!** Do not use this appliance near bathtubs, showers, basins or other vessels containing water.
- Do not immerse the appliance in water or other liquids.
- Keep the appliance dry.
- **UK Only:** Do not use this appliance in the bathroom. A circular icon with a diagonal slash through it, containing a simplified drawing of a bathtub.
- **Outside the UK:** If using the appliance in a bathroom, unplug after use as the proximity of water can be

dangerous even if the appliance is switched off. For additional protection the installation of a residual current device (RCD) with a rated residual operating current not exceeding 30mA is advisable in the electrical circuit supplying the bathroom. Ask your installer for advice.

- The appliance's charging stand and/or adaptor must be kept away from sources of water so that they do not fall into the water.
- **CAUTION!** Keep the power cord and the appliance dry.
- Always inspect the appliance before use for noticeable signs of damage. Do not use if damaged or if the appliance has been dropped. In the event of damage contact the Conair Customer Care Line (refer to 'UK After Sales Service' section for further information).
- Do not use the appliance if the charging adaptor or lead is damaged. In the event of damage, discontinue use immediately. If the charging adaptor or lead is damaged, it must be replaced by the manufacturer. Return the appliance to the Customer Care Centre (refer to 'UK After Sales Service' section for further information). No repair must be attempted by the consumer.
- Only use the attachments supplied with this appliance.
- **WARNING!** For the purposes of recharging the battery, only use the detachable charging supply unit provided with this appliance. (CA78M Regular Adaptor or CA88M USB Adaptor). This symbol  indicates there is a detachable power supply for means of charging.
- Do not leave the appliance unattended when switched on.

- Do not leave the appliance plugged in for more than 24 hours.
- Unplug immediately if any problems occur during use.
- Do not place the appliance on any surface whilst in operation.
- Special care is required when using the appliance close to the ears, eyes and face.
- This appliance may be used by children aged from 8 and older and people with reduced physical, sensory or mental capabilities or lack of experience and knowledge if they have been given supervision or instruction on the safe use of the appliance and understand the hazards involved. Children must not play with the appliance.
- This product contains a lithium ion battery that has a removable battery that can be charged separately and shared across compatible products. Batteries must be disposed of safely at the end of life. Please take to a recycling centre for safe disposal. If the battery leaks, avoid touching it and dispose of it at a recycling centre.
- The supply terminals are not to be short circuited.
- This product complies fully with all appropriate EU and UK Legislation and the standards relevant to this type and class of appliance. We are an ISO9001:2015 certified company that continually evaluates our Quality Management System performance. If you have any queries regarding product safety and compliance, please contact the Conair Customer Care Line (refer to 'UK After Sales Service' section).

WEEE - END-OF-LIFE ELECTRICAL AND ELECTRONIC EQUIPMENT

In everybody's interest and to actively participate in protecting the environment and human health:

- Do not discard your products with your unsorted household wastes.
- The WEEE (Waste electrical and electronic equipment) must be collected separately.
- Use the return and collection systems dedicated to the WEEE available in your area. In this way, some materials can be recycled, re-used or recovered.
- By ensuring this product is disposed of properly, you will help prevent potential negative consequences for the environment and human health due to possible content of hazardous substances.

For more detailed information about the disposal of this product, please contact your local household waste disposal service.

TECHNICAL DATA

USB-C adaptor	CA88M
adaptor	CA78M
Vibrations	< 2.5 m/s ²
LpA (dB(A))	< 70

ON/OFF SWITCH

To operate, simply slide switch to ON (marked «I»). To stop operation, set to the OFF (marked «0») position. Make sure the switch is in the OFF (“0”) position when the clipper is not being used.

VERY IMPORTANT: BLADES MUST BE CLEANED AND OILED ON A REGULAR BASIS FOR PROPER FUNCTIONING. FAILURE TO REGULARLY CLEAN AND OIL THE BLADES WILL VOID THE WARRANTY.

USER MAINTENANCE INSTRUCTIONS

MAINTENANCE OF THE BLADE

Always apply oil to the blades before and after use. This will ensure maximum cutting performance and proper maintenance. Hold the clipper away from your body in a downward position and apply a drop of BaBylissPRO lubricating oil on the front and sides of the cutter blade. Wipe off excess oil with a soft, dry cloth.

Do not pull, twist, or wrap the power cord around the appliance.

HOW TO USE COMB ATTACHMENTS

To use the comb attachments, turn the clipper to the «0» (OFF) position. Slide the comb attachment onto the top of the clipper blade, and then pull down and over the back of the blade. To remove, pull up on the back of the comb attachment and then pull away from the blade.



Fig. 2

REPLACEMENT (REMOVAL) OF BLADE SET

Step 1. Unplug the unit and adjust the taper (see position in illustration A).

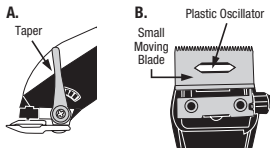

Step 2. Remove the screws and the fixed blade. Save the screws.

Step 3. Lift off the small moving blade and replace it with the new one on the plastic oscillator (see illustration B).

Step 4. Replace the fixed blade using the screws and lightly tighten them. Adjust the teeth, as shown in illustration C, to a gap of 0.3mm to 1.0mm. The small, moving blade should be as centered and as parallel as possible to the fixed blade's teeth.

IMPORTANT NOTE:

The top edge of the fixed blade must be a minimum of 0.3mm higher than the top edge of the moving blade and as centered as possible. This is important so that the moving blade does not come in contact with the skin.

Be sure to add a few drops of BaBylissPRO lubricating oil to the blades before running the clipper. Don't forget to tighten the screws after the blades have been aligned.

BLADE SHARPENING

BaBylissPRO cutting blades are ground from the finest quality graphite and are hardened to extend the cutting performance. As with any cutting appliance, the cutting edges become dull from repeated use. Increasing blade tension to force the blade cutting would cause the clipper to overheat and reduce its motor life. When the blade is no longer able to cut smoothly, sharpening is required or replace it with a new BaBylissPRO blade set.

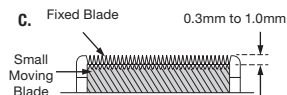

ADJUSTABLE TAPER LEVER

The taper lever is positioned at your thumb. You can hold the clipper in your hand and adjust the lever while you are clipping.

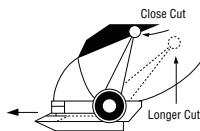

The taper lever adjusts the closeness of the cut—from a close cut with the taper lever in the up position to a longer length cut with the taper lever in the down position. To increase cutting length, slowly push the lever down. To cut closer, push the lever up. As different cutting edges are used in each setting, using the taper lever lengthens the life of the clipper blades. Hair buildup can slow down the clipper. Keep the clipper on for removing hair. Then push the taper lever back and forth quickly several times. If you do this every time, especially after cutting a lot of hair, the clipper blades should remain free of cut hair. Oil the blades after the above procedures.

BATTERY REMOVAL AND INSTALLATION

The FX829U clipper features a removable, rechargeable, and interchangeable battery, so you can cut and style for extended amounts of time with minimal interruption. Be sure clipper is in the OFF (“0”) position before removing or installing the battery.

1. To remove the battery, press on the battery release button on the back of the clipper handle toward the middle of the unit



Battery Release Button

2. The battery will partially eject but needs to be pulled from the bottom of the clipper to remove completely.
3. To install the battery, line up the keyway of the clipper with the battery housing, aligning the arrow mark on the battery with the arrow mark on the clipper. Insert the battery into the opening and push into the housing until the locking mechanism engages.

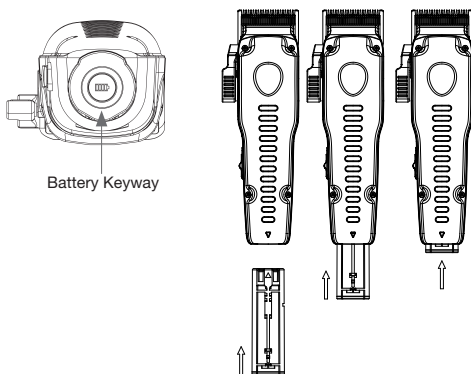

WARNING – Make sure the clipper and battery are aligned properly before pushing battery all the way in. Do not force battery in if any resistance is felt.

DISPOSAL OF LITHIUM-ION BATTERIES

1. The batteries for this clipper set are protected in a plastic housing.
2. Press the battery release button and pull battery housing out of clipper
3. No further disassembly of the battery unit is required.
4. Take to an authorized battery recycling center and recycle entire battery unit.

IMPORTANT

Do not use this appliance with a damaged or broken comb, as it has the potential to result in facial injury.

Keep the appliance cord away from heated surfaces.

Make sure the switch is in the OFF "0" position when the clipper is not operating. Plug charging stand into outlet to charge batteries. To disconnect, first remove batteries from charging stand, then unplug from outlet. Use of a charging stand not sold by BaBylissPRO may result in risk of fire, electric shock, or injury to person.

Do not disassemble charging stand. Incorrect reassembly may result in a risk of electric shock or fire. When repair is required, send or take it to a BaBylissPRO Authorized Service Center. The batteries for this clipper are designed to be easy to use. However, like all batteries, they will eventually wear out. Do not attempt to replace the batteries. When replacement is required, contact a BaBylissPRO Authorized Service Center. Batteries can be harmful to the environment if disposed of improperly. Many communities offer recycling or battery collection. Contact your local government about disposal practices in your area. **WARNING:** Never touch both terminals on clipper with metal objects and/or body parts, as short circuit may result. Keep away from children. Failure to comply with these warnings could result in fire or serious injury. This clipper is intended for trimming purposes only.

This product is for commercial use.

CHARGING STAND INSTRUCTIONS

The FXONE Universal Battery Charging Stand can be powered by either the universal FXCORD (not included) or a USB-C adaptor.

To use a USB-C adaptor: Connect the USB-C adaptor to the USB-C port at the back of the FXONE Universal Battery Charging Stand, then insert the battery into the charger.

To use the universal FXCORD: Connect the standard charging cord (FXCORD) to the standard port at the back of the FXONE Universal Battery Charging Stand, then insert the battery into the charger.

To insert the battery into the charging stand: Align the arrow mark on the battery with the arrow mark on the charger, then insert the battery into the opening and push into the housing until the locking mechanism engages.

Warning: Only use with FXCORD AC adaptor CA78M (not included) or USB-C adaptor CA88M provided with the appliance.

Rated Output:

Universal FXCORD CA78M: 4.5VDC, 1.2A (not included)

USB-C adaptor CA88M: 5.0VDC, 2.0A

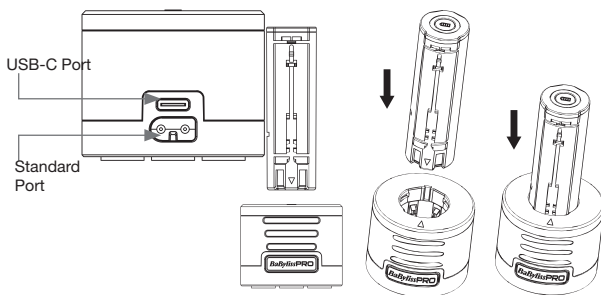

BATTERY/CHARGING INDICATOR (TOP OF FXONE BATTERY)

Blue flashing – Charging

Blue solid – Charged (see charge levels below)

- The charging stand may become warm while charging. This is normal.
- Preserving the battery: In order to maintain the optimum capacity of the rechargeable battery, it should be recharged for 3 hours approximately every 6 months.

WARNING: If the charging light suddenly starts to flash rapidly, the battery is faulty. If this happens, stop charging, unplug the FXONE Universal Battery Charging Stand from the outlet/USB power source and contact our Customer Care Center for further advice.

BATTERY CHARGE-LEVEL INDICATOR

The FXONE Universal Battery has a built-in 4-stage LED ring light to indicate charge level of the battery. To check charge level, press on the central button on the bottom of the battery housing to display current charge level.

Full circle – 100% charge

$\frac{3}{4}$ circle – 75% charge

$\frac{1}{2}$ circle – 50% charge

$\frac{1}{4}$ circle – 25% charge

Battery Level
Indicator Button

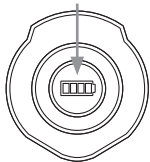

Read these instructions carefully before connecting the charging stand to any power supply. **OPERATION**

1. For dry use only. Do not expose to water.
2. When not in use, unplug unit completely.
3. Unit will become warm during operation.

CLIPPER OPERATING PRECAUTIONS

This Clipper has a removable rechargeable battery. Do not throw device or battery into fire, apply heat, or charge, use, or leave in a high-temperature environment.

If the clipper is to be stored unused for a long period, the FXONE Universal Battery should be removed.

UK GUARANTEE

This BaByliss PRO appliance is guaranteed for professional use for 2 years and is only valid within the United Kingdom.

Exclusions

This guarantee will no longer be valid meaning that The Conair Group Ltd will not be liable to repair or replace your product where:

- 1.) The appliance has been used on a voltage supply other than that which is marked on the product, or advised within this instruction booklet.
- 2.) The appliance has been purchased from an unauthorised stockist*.
- 3.) Repairs or alterations have been attempted by unauthorised persons.
- 4.) The failure of the appliance is a direct result of misuse.
- 5.) The failure is a result of not following the instructions for use.

This guarantee does not cover any cosmetic damage due to misuse of the product nor any damage to persons or property that occurs because of product misuse.

*unauthorised stockists include, but are not limited to online auction sites, private sellers and those selling second hand goods, refurbished products etc.

Please contact the Conair Customer Care Line on 03705 133 191 (09:00 to 17:00 Monday to Friday) or e-mail ukinfo@conair.com for further information on authorised stockists.

It is important to retain your proof of purchase. We recommend attaching your receipt to this page.

Even where a refund may be applicable, no refund will be provided without a valid receipt or proof of purchase, we will only be able to offer a repair or replacement service. Please note this does not apply if the product was purchased directly from The Conair Group Ltd.

Guarantees on replacement products run from the original purchase date or date of delivery, whichever is later, and **not** from the date of replacement.

This guarantee is an additional benefit and does not affect your statutory rights as a consumer.

If you have any queries regarding this guarantee please contact the Conair Customer Care Line on 03705 133 191 (09:00 to 17:00 Monday to Friday) or e-mail ukinfo@conair.com.

UK AFTER SALES SERVICE

For further advice on using the appliance or should you need to return your product, please contact the Conair Customer Care Line on 03705 133 191 (09:00 to 17:00 Monday to Friday) or e-mail your enquiry to ukinfo@conair.com.

Return address:

Customer Care Centre
Conair Logistics
Unit 4, Revolution Park
Buckshaw Avenue
Buckshaw Village
Chorley
PR7 7DW

Please enclose your returns number, name and address details, together with a copy of proof of purchase and details of the fault.

Please note this Instruction Booklet is not the guarantee.

SAFE DISPOSAL



The  symbol on the product or on its packaging indicates that this product may not be treated as household waste. Instead it should be handed to an appropriate collection point for the recycling of Electrical and Electronic equipment. By ensuring this product is disposed of correctly, you will help prevent potential negative consequences for the environment and human health, which could otherwise be caused by inappropriate waste handling of this product. For more detailed information about the recycling of this product, please contact your local council office or your household waste disposal service.

UKCA DECLARATION OF CONFORMITY

In accordance with UK Government guidance

We, the undersigned, take full responsibility for the product's compliance.

Type of product	: Clipper
Type number	: T183a
Trademark	: BaBylissPRO / Conair / CPL
With following characteristics	: Unit : 3.6VDC, 8.71Wh (2.42Ah) / 3.6VDC, 11.88Wh (3.3Ah) Charging stand: 4.5VDC, 1.2A, 5.4W / 5.0VDC, 2.0A, 10.0W Adaptor : 100-240V~, 50-60Hz, 4.5VDC, 1.2A, 5.4W / 5.0VDC, 2.0A, 10.0W
Country of origin	: China
Manufacturer name	: Conair UK
Address	: PR7 7DW

The object of the declaration described above is in conformity with the relevant UK Statutory Instruments (and their amendments):

2016 No. 1101	Electrical Equipment (Safety) Regulations 2016
2016 No. 1091	Electromagnetic Compatibility Regulations 2016
2012 No. 3032	Restriction of the use of certain Hazardous Substances in Electrical and Electronic Equipment Regulations 2012
2019 No. 539	Ecodesign for energy-related products and energy information (Amendment) (EU Exit) Regulations 2019
2008 No. 1597	Supply of Machinery (Safety) Regulations 2008

References to the relevant designated standards used or references to the other technical specifications in relation to which conformity is declared:

LVD	BS EN 60335-1	2012	A2 :2019 ; A15 :2021
	BS EN 60335-2-8	2015	A1 :2016 ; A12 :2022
	BS EN 62233	2008	
EMC	BS EN IEC 55014-1	2021	
	BS EN IEC 55014-2	2021	
	BS EN IEC 61000-3-2	2019	A1:2021
	BS EN 61000-3-3	2013	A1:2019; A2:2021; AC:2022
RoHS	BS EN IEC 63000	2018	
	BS EN 62321-3-1	2014	
	BS EN 62321-5	2014	
	BS EN 62321-4	2014	A1:2017
	BS EN 62321-7-1	2015	
	BS EN 62321-7-2	2017	
	BS EN 62321-6	2015	
	BS EN 62321-8	2017	
EuP	BS EN 50563	2011	A1:2013

The technical documentation is available from:

Name: The Conair Group Ltd,

Address: Unit 4, Revolution Park, Buckshaw Avenue, Buckshaw Village, Chorley, PR7 7DW

Signed by and on behalf of:

BABYLISS FACO S.R.L. (authorised by BABYLISS S.A.R.L. and The Conair Group Ltd)

Avenue de l'Indépendance 25, B-4020 Wandre, Belgium

Place: Wandre



